



TRILOBE

COLLECTION
LES MATINAUX AND NUIT FANTASTIQUE

USER MANUAL

User manual

SUMMARY

P5. The spirit of the brand

P7. Unique way of reading time

P10. At the heart of the watch specificities

P14. The Trilobe watch

P16. The power reserve

P19. Set the time of day

P22. Strap, want to change?

P24. Maintenance: it's your move!

P26. Better safe than sorry

P28. Our quality approach

P30. Our warranty

P32. Any questions? Contact us!

THE SPIRIT OF THE BRAND



Hands less, but with a sprinkle of magic!

You enjoy difference!

Here is Trilobe, a new way of reading time.

3 rings, 3 indicators, a new frame of reference.

No more hands and preconceived notions.

Innovation is put at the service of creation.

An alliance of daring, architecture and poetry.

A watchmaking innovation and expertise compendium.

A movement that liberates time.

An urgent invitation to take your time.

Trilobe. **Time. Liberated.**

This user manual is valid for **Les Matinaux** (The Dawn Breakers)
and **Nuit Fantastique** (Fantastic Night) collections.

To know more about Trilobe watches:

<https://trilobe.com>

**The Trilobe watch reverses time display,
putting the motion of time at its centre and
fixing its indicators**

Time is given by 3 rotating eccentric rings
carrying the scales of time (hours, minutes
and seconds)

Each component of time has its own display
(indicator and annular disc), allowing it to
follow its own path. Each component display is
resized: the largest ring for hours, the median
one for minutes, the smallest one for seconds.

Each ring moves in a counterclockwise direction.

UNIQUE WAY OF
READING TIME

LES MATINAUX COLLECTION

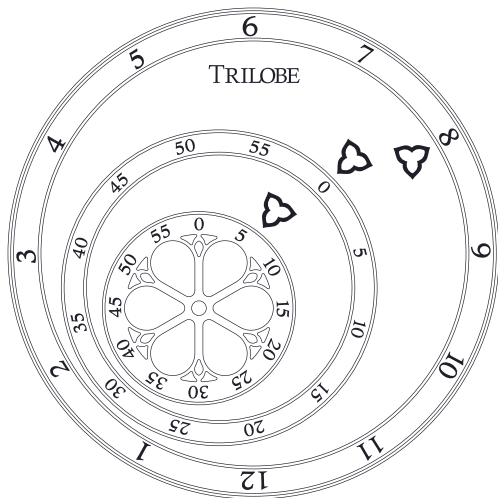

It is 08 hours, 0 minute and 6 seconds

NUIT FANTASTIQUE COLLECTION

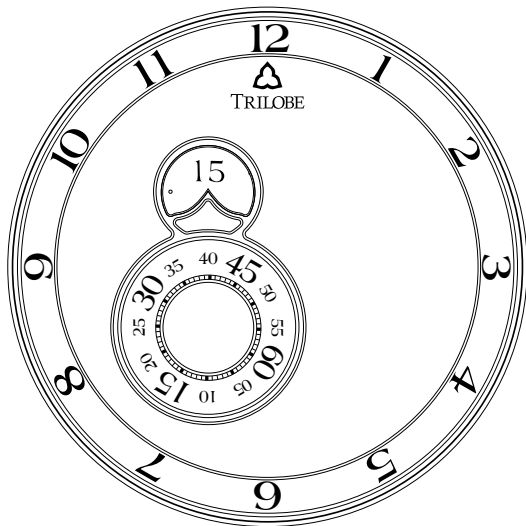

It is 12 hours, 15 minutes and 40 secondes

AT THE HEART
OF THE **WATCH**
SPECIFICITIES

Les Matinaux collection

MOVEMENT - THE X-CENTRIC CALIBRE

Trilobe's signature movement. Self-winding mechanical calibre with a micro-rotor.

BALANCE FREQUENCY

28'800 vph (4 Hz)

POWER RESERVE

48 hours

FUNCTIONAL RUBIES

33

TOTAL PIECES IN THE MOVEMENT

230

FUNCTIONS

Hours, minutes, seconds displayed by rotating rings and fixed indicators

MOVEMENT DIMENSIONS

Thickness : 5,78 mm | Diameter : 35,2 mm

STRAP

Leather with a pin buckle

PATENT

A display concept composed of three devices representing the hours, minutes and seconds located on the same plane as the dial

CASE

Made of 316L stainless steel, grade 5 titanium, or 18-carat rose gold

Thickness: 8.8 mm | Diameter : 40.5 mm and 38.5 mm

Lug to lug : 45.5 mm (in 38.5 mm) and 48 mm (in 40.5 mm) | Lug width : 20 mm

Made up of 7 pieces

Mirror-polished surfaces alternating with satin-brushed treatments

Domed bezel with sapphire crystal and multi-layered anti-reflective treatment (ARDUR)

Brought horns. Anti-reflective sapphire back

Water-resistance tested to 5 bar (= 50 meters) for the steel/titanium version and 3 bar (= 30 meters) for the rose gold version

AT THE HEART OF THE **WATCH** **SPECIFICS**

Nuit Fantastique collection

MOVEMENT - THE X-CENTRIC CALIBRE

Trilobe's signature movement. Self-winding mechanical calibre with a micro-rotor.

BALANCE FREQUENCY

28'800 vph (4 Hz)

POWER RESERVE

48 hours

FUNCTIONAL RUBIES

33

TOTAL PIECES IN THE MOVEMENT

230

FUNCTIONS

Hours, minutes, seconds displayed by rotating rings and fixed indicators

MOVEMENT DIMENSIONS

Thickness : 5,78 mm | Diameter : 35,2 mm

STRAP

Leather with a pin buckle

PATENT

A display concept composed of three devices representing the hours, minutes and seconds located on the same plane as the dial

CASE

Made of 316L stainless steel, grade 5 titanium, or 18-carat rose gold

Thickness: 9,2 mm | Diameter : 40,5 mm and 38,5 mm

Lug to lug : 45,5 mm (in 38,5 mm) and 48 mm (in 40,5 mm) | Lug width : 20 mm

Made up of 7 pieces

Mirror-polished surfaces alternating with satin-brushed treatments

Domed bezel with sapphire crystal and multi-layered anti-reflective treatment (ARDUR)

Brought horns. Anti-reflective sapphire back

Water-resistance tested to 5 bar (= 50 meters) for the steel/titanium version and 3 bar (= 30 meters) for the rose gold version

THE TRILOBE WATCH

LES MATINAUX COLLECTION

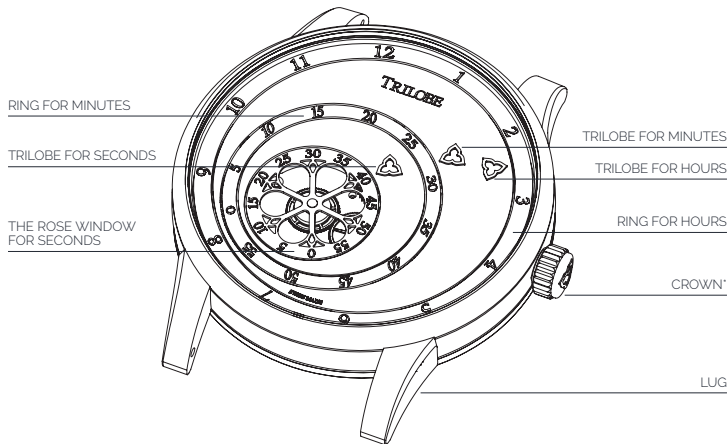

*Screw down crown for Les Matinaux with a diameter of 40,5 mm
and push button crown for Les Matinaux with a diameter of 38,5 mm

THE TRILOBE WATCH

NUIT FANTASTIQUE COLLECTION

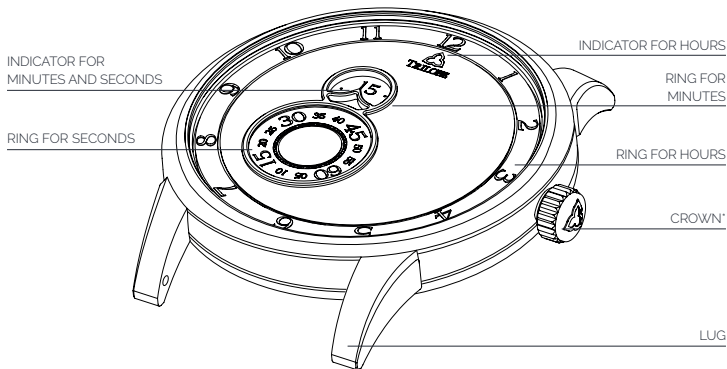

*Screw down crown for Nuit Fantastique with a diameter of 40.5 mm and
push button crown for Nuit Fantastique with a diameter of 38.5 mm

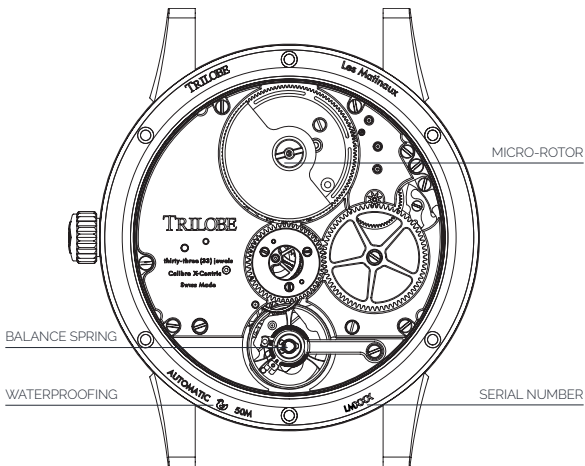

This function allows you to collect the necessary energy for the proper functioning of your automatic mechanical watch

The specificities of the micro-rotor

Your Trilobe watch is equipped with a micro-rotor movement. The micro-rotor is a technical exception which is distinguished by its size, shape and position: a small, thick half-disc, made of tungsten, integrated into the height of the movement. The micro-rotor is a know-how and innovation compendium. It allows for a self-winding movement without altering its aesthetics and elegance. Indeed, this mechanism offers a clear view on all the movement's components. The use of a micro-rotor also reduces the thickness of the movement, making Trilobe's X-Centric calibre only 5.78 mm thick.

Wearing your watch

The micro-rotor accumulates energy through the movements of your wrist, giving your watch a power reserve of at least 48 hours. The micro-rotor requires a specific winding of the movement.

The efficiency of the mechanism is always a function of the activity of the wrist, but the sensitivity of the micro-rotor is lower than the one of an oscillating weight. For optimal charging time, allow 13 hours of wear. Broad movements, a sitting position, or a loosen strap, reduce the intensity of the movements thus causing the watch to lose a large part of its winding capacity. It may therefore be necessary to regularly wind your watch manually for an optimal autonomy.

Winding your watch

If you have not worn your watch for more than 24 hours or if your daily wearing time is less than 13 hours, we recommend that you manually wind your watch by 71 turns for an optimal power reserve. To wind your watch, unscrew the crown by about ten turns (downwards) and then turn it by 71 turns (upwards). In the case of a push-button crown (on 38.5 mm cases), simply turn the crown upwards by 71 turns.

SET THE TIME OF DAY

LES MATINAUX COLLECTION

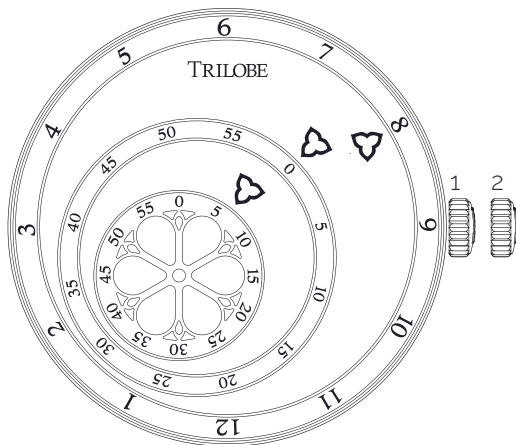

SET THE TIME OF DAY

NUIT FANTASTIQUE COLLECTION

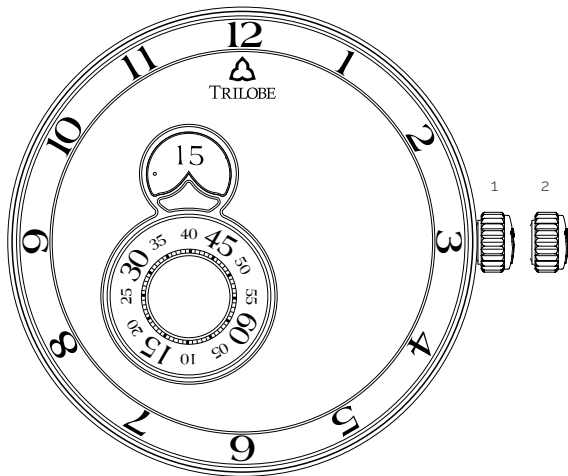

This function allows your watch to be set to the correct time by using the crown

WEARING POSITION - POSITION 1

The crown must be in position 1 when the watch is running. The crown, thus positioned, guarantees the water-resistance of the watch. After each use of the crown, make sure it is fully pushed or screwed against the case.

SETTING TIME POSITION - POSITION 2

As for a screw down crown, unscrew the crown by rotating it downwards for about 10 turns. Then, pull the crown out to position 2. Rotate the crown in either direction to position the trilobes according to the hours and minutes of the desired time. For greater accuracy in setting time, wait for the seconds ring to reach the targeted number, typically "0". When you reach the desired time position, push the crown back. Finally, screw the crown in position 1 by pressing it while rotating it upward until it is fully pressed against the case. As for a push button crown, simply pull out the crown to position 2. Then rotate the crown in any direction to set the correct time. When you're done, push the crown fully against the case in position 1.

STRAP, **WANT**
TO CHANGE?

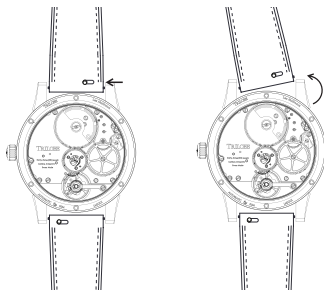

1. Turn on the presto spring lug attachment by pulling it towards the center of the strap to remove the first part of the wristband
2. Insert one end of the bar of the new wristband
3. Put the wristband back on while activating the presto spring lug attachment by pulling it to the left
4. Release the presto spring lug attachment
5. Repeat the previous steps for the other part of the wristband

MAINTENANCE: IT'S YOUR MOVE!

A watch is a delicate object that requires care. In order to keep your watch looking its best, we recommend that you groom it regularly.

GROOMING

A microfiber towel has been provided with your watch and we recommend that you gently clean the case with it so as not to scratch it.

LEATHER WRISTBAND

The life span of a leather wristband depends on the conditions and frequency of use. To maintain it, we recommend that you avoid contact with water, fatty or acid substances, and cosmetic products. You should also avoid excessive exposure to sunlight, as UV rays can affect its coloring. We do not recommend the use of leather care products to clean or restore shine to a wristband. In summer, a leather strap is subject to more external aggressions. Therefore, during this period you should temporarily replace your leather strap by a rubber strap adapted to the model of your watch. The leather wristband must be treated with special care in order to preserve its shine and suppleness as long as possible. To do so, gently rub the leather strap with a soft cloth or microfiber

cloth before storing the watch in its box. The wristband change is easily carried out thanks to the integrated presto spring lug attachment system.

COMPLETE OVERHAUL

The accuracy mechanism of Trilobe watches is particularly sophisticated due to complications of high-end watchmaking, which enable the brand's characteristic way of reading time. It is therefore recommended to contact our Trilobe authorized service center approximately every 3 years for regular maintenance and every 5 to 7 years for a complete overhaul.

BETTER SAFE THAN SORRY

TEMPERATURE

Avoid extreme temperatures or sudden variations. The movement of your watch is a top-of-the-range precision mechanism that requires to be protected from extreme temperatures (+60°C, -0°C) and thermal shocks (e.g. hot springs, high temperature showers, sauna, steam room, journey to the center of the Earth).

WATERPROOFING

Trilobe watches are water-resistant to 5 bar/ATN for the steel/titanium version (approximately 50 meters) and 3 bar/ATN for the rose gold version (approximately 30 meters). The shower or tap flow can

easily exceed the pressure of 5 or 3 bar and jeopardize the waterproofing of your watch. To ensure the water-resistance of the watch, always make sure that the crown is screwed or pushed against the case as far as possible, especially before each use in the water. In general, we strongly recommend that you avoid wearing your watch for any aquatic activity and keep it away from water. Any damage caused by improper use of the watch is not covered by the warranty. Your wristband might also be damaged. Never handle the crown underwater. Trilobe watches are sealed by safety seals that can be damaged by natural wear, temperature changes, shocks or cosmetics. If condensation appears

under the glass of your watch, it means that its sealing system is damaged : if so, it is recommended to contact our after-sales center.

PROTECTING YOUR WATCH

In case of immersion in seawater or chlorinated water, we recommend that you clean your watch with a soft cloth soaked in slightly warm fresh water. Avoid direct contact with chemical cleaning agents, solvents, detergents, and other abrasive and cosmetic products that may damage the case, wristband or rubber seals.

MAGNETISM

Wearing or placing your watch near electronic devices that may generate magnetic fields is detrimental to its proper functioning. Magnetic fields are emitted from different sources, such as mobile phones, computers,

refrigerators and other electronic devices. These magnetic fields can cause a sudden change in the accuracy of your watch. Watches are designed to resist radiations encountered in everyday life, but some strong disturbances are likely to magnetize steel components of the movement, in particular the balance-spring. In this case, contact our after-sales center so that a watch specialist can examine your watch and carry out a simple demagnetization procedure.

VIBRATIONS

Avoid vibrations and impacts on the watch (golf, tennis, mountain biking, moon landing, etc.). Shocks can damage not only the external parts but also the accuracy of the movement. Any damage caused by improper use of the watch is not covered by the warranty.

OUR
QUALITY

APPROACH

We are committed to providing you with excellent product quality and service level. All our watches are subject to the highest quality controls. Following a first round of tests, our watches go through hundreds of hours of internal quality control in 6 steps:

- Regularity control
- Waterproofing control
- Impact control
- Temperature control
- Power reserve control
- Aesthetic control

OUR WARRANTY

Each Trilobe watch has a unique identification number that testifies to its authenticity. We provide two types of warranty: the first covers manufacturing defects, the second covers technical interventions carried out on the watch.

COMMERCIAL WARRANTY

Your Trilobe watch is guaranteed against any manufacturing defect for 24 months from the date of shipment or hand delivery, provided that the warranty card is signed by Trilobe or a retailer approved by Trilobe. Any repair or overhaul work performed by a third party not approved by Trilobe would automatically invalidate the warranty.

The warranty does not cover the following cases:

- Damage resulting from improper handling; (refer back to our maintenance and precautions sections)
- Watch wearing out;
- Shocks (our X-Centric movement has two shock indicators to assess the magnitude of an impact);
- Watch loss or theft.

TECHNICAL WARRANTY

After any intervention carried out by an approved Trilobe repairer, the repair work is guaranteed for a period of 12 months. This warranty does not cover ordinary wearing out or any damage resulting from improper handling. In the event of damage caused by an unauthorized repairer, the watch must be repaired at your own expense.

To be valid, the warranty card, located at the end of this user manual, must have been duly completed and signed by Trilobe or a retailer approved by Trilobe.

ANY QUESTIONS?
CONTACT US

Our Trilobe service center is staffed with carefully selected and certified personnel to meet the highest quality standards. In order to preserve the value of your Trilobe watch, make sure that it is always examined by an approved Trilobe watchmaker.

For technical support, you can ship your watch to our service center. Visit our service section on <https://trilobe.com/en/services/>

Would you like to meet us? Do you have any questions? Do you need some advice? We are at your disposal. Do not hesitate to contact us.

cercle@trilobe.com

Direct line: **+33 (0)1 42 33 52 96**

Monday to Friday from 10am to 7pm (CET)

Saturday from 10am to 5pm (CET)

<https://trilobe.com>



TRILOBE INTERNATIONAL **WARRANTY**

Ref. N° :

Serial number :

Date & place of purchase :

Authorized dealer stamp :